

Temporarily Close Salting Street for Landscaping

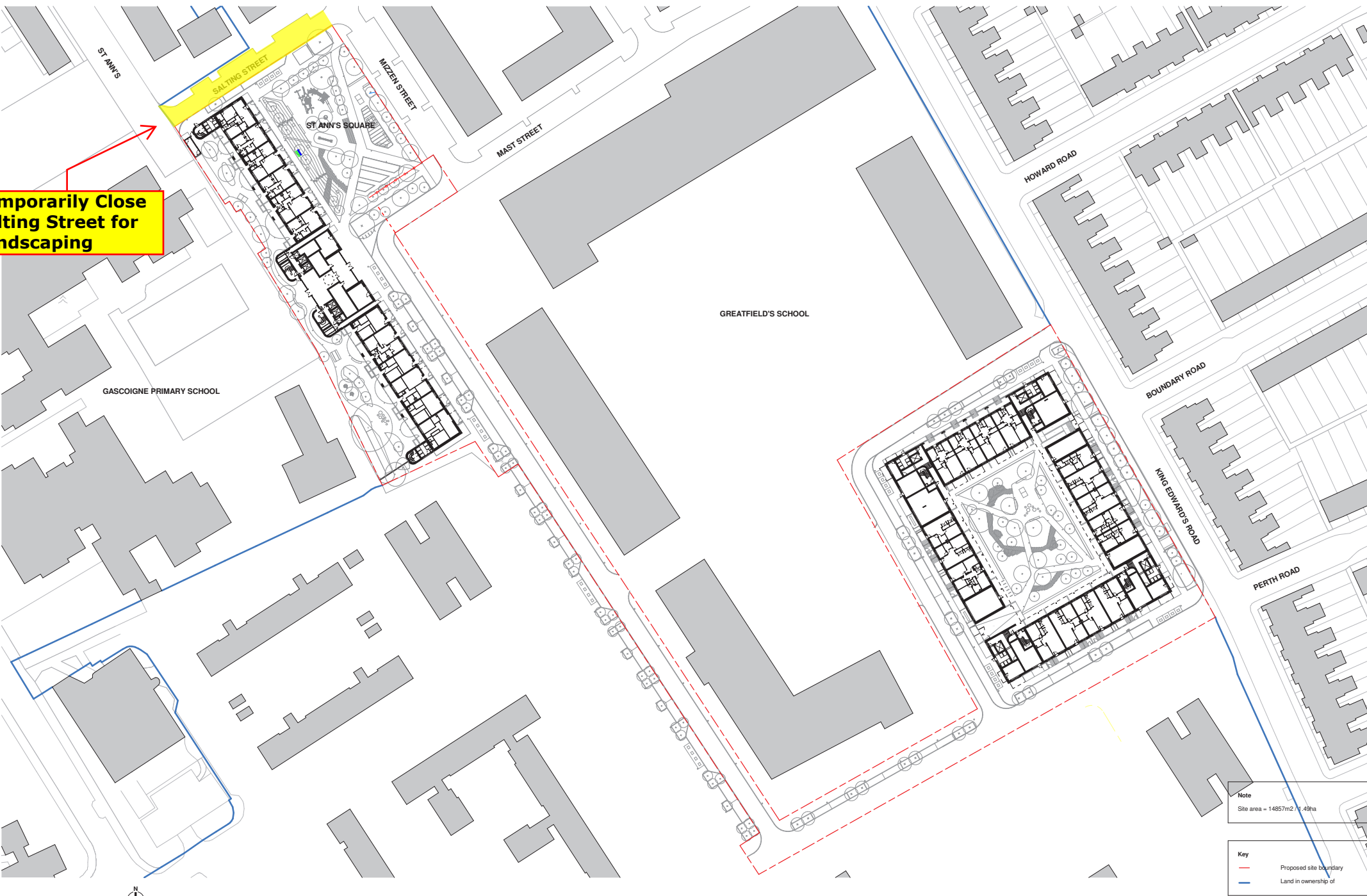

Note
Site area = 14857m² / 1.49ha

Key
- - - Proposed site boundary
— Land in ownership of

PITMAN TOZER ARCHITECTS
 209 Old Marylebone Road
 London NW1 5QT
 tel 020 3214 3255
 mail@pitmantozer.com
 www.pitmantozer.com

General Notes
 1. This drawing remains copyright of Pitman Tozer Architects Limited and may not be reproduced or copied without consent in writing.
 2. Do not scale drawing - use figure dimensions only.
 3. Any discrepancies between site and drawings to be reported to the architect immediately.
 4. Read in conjunction with all relevant structural and mechanical & electrical engineers drawings.
 5. Dimensions critical to proposed building works must be checked on site before building works commence, as certain assumptions have been made due to lack of accessibility and anomalies in the existing building.

Other Notes

Revision	Date	By	Of	Notes	Project Address	Drawing status	Drawn
P1	10.06.20	HF	HR	First Issue	Barking, IG11 7EE	Planning	HF
Plot I & J - Proposed Site Plan						Date	Checked
						10.06.20	HR
Drawing number: BF0147-PITA-ZZ-00-MP-A-060310						Scale	Revision
						1:500 @ A1	P1
						1:1000 @ A3	